

CERTIFIED RECORD OF LAND CORNER MONUMENTATION

History of original corner establishment:
New corner

*

DIAGRAM
T10S R32E
C1/4
+
S24

Description of corner evidence found:

Description of monument and accessories I establish to perpetuate the original location of this corner:

Set a 2-1/2x30" aluminum monument 18" in the ground.
New BTs:
A 18" Fir bears N39°32'W 31.1 ft scribed C1/4S24BT.
A 9" Fir bears S47°32'W 17.9 ft scribed C1/4S24BT.

T10S R32E
C1/4
+
S24
PLS1918
1989

New BTs have 3/4" brass washers marked PLS1918 attached to the BT blaze, faces and bands painted with red tree marking paint, and BT tags and Attention or Land Survey Monument signs. A steel fence post with Attention or Land Survey Monument sign is driven approximately 3-5 feet from the corner.

Sun Cadastral Survey
Contract No.: 53-04H1-7-4011
Project No.: 8722LB
Field Book: 7-72
Work Accomplished: 6/7/89
Witnesses: Louise Parsons

PARSONS SURVEYING
1915 S.E. Stone Street
Corvallis, OR 97333
(503) 752-7515

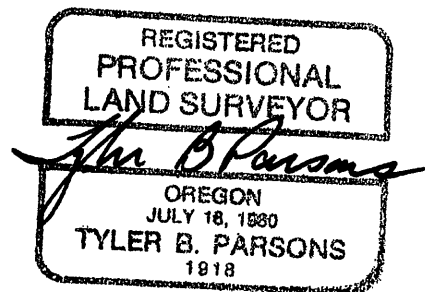

Office of COUNTY SURVEYOR County of GRANT
State of OREGON, I hereby certify that the within instrument was filed in this office
for record on the 10 day of Aug, 1989

Robert D. Baggett by _____
(COUNTY OFFICIAL) (DEPUTY)